

SECTION 00 91 13

ADDENDA

Addendum #1 (10/29/24): Plan revisions, callouts and details by Architect addressed, Bid Specification clarifications, irrigation wiring clarification and landscaping material substitutions.

Addendum #2 (10/31/24): Irrigation plans, materials and specifications clarification, and Bid Specifications clarification.

Addendum #3 (11/07/24): Clarification of materials provided by NOR and installed by Contractor, confirmation of irrigation design, electrical and soil preparation, Seed Mix ratio and specifications updated, and Addition of detail to Engineered Wood Fiber (EWF) adjacent to native soil.

END OF SECTION

**SECTION 00 63 13
REQUEST FOR INFORMATION FORM**

Project: <u>Polo Community Park Bark Park and</u>	R.F.I. #: <u>8</u>
<u>Landscape Improvements</u>	From: <u>JTS Construction</u>
To: <u>North of the River Recreation & Park District</u>	Date: <u>11/6/2024</u>
Re: <u>Wood Fiber transition</u>	Proj. #: <u>POLO-1-2425</u>

Specification Section: _____ Paragraph: _____ Drawing Sheet: _____ Detail: _____

Request: All details provided for the Engineered Wood Fiber shows it against 12" Concrete Thickened Edge.

Per LC01 the Engineered Wood Fiber's perimeter is against Native Soil. Please provide the Detail for the transition of Engineered Wood Fiber to Native Soil or advise if the perimeter will be the 12" header. Please see attached screen shot of drawing with transition in question marked in red.

Signed By: _____ Printed Name: _____ Date: _____
Response:

1. See Attached Detail - EWF Shovel Cut Edge.

Attachments:

Response From: BO Admin. To: BIDDERS Date Open: 11.06.24 Date Ret'd: 11.07.24

Signed by:  Date: 11.07.24

Printed Name: Josh Herrbort

END OF SECTION

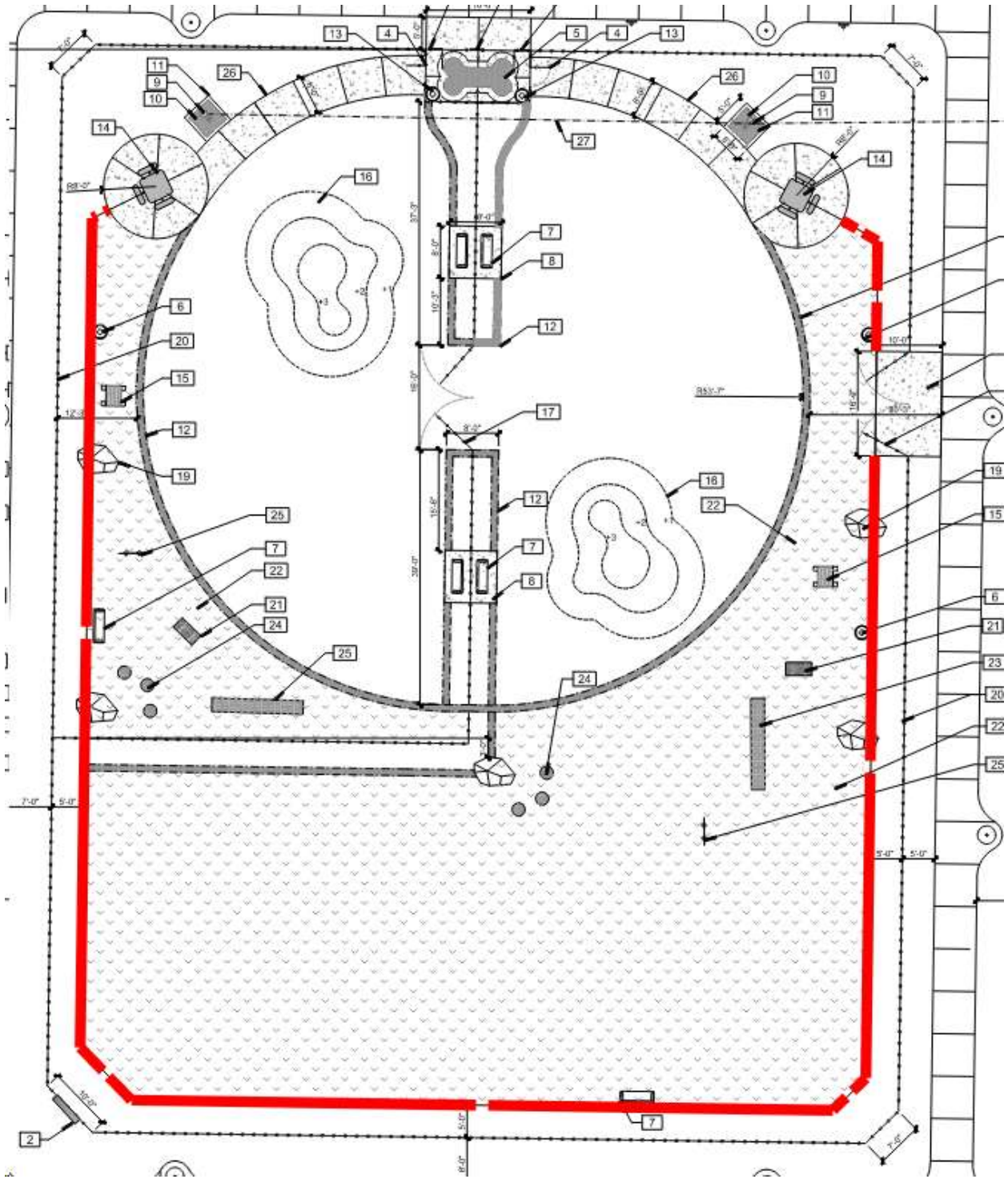

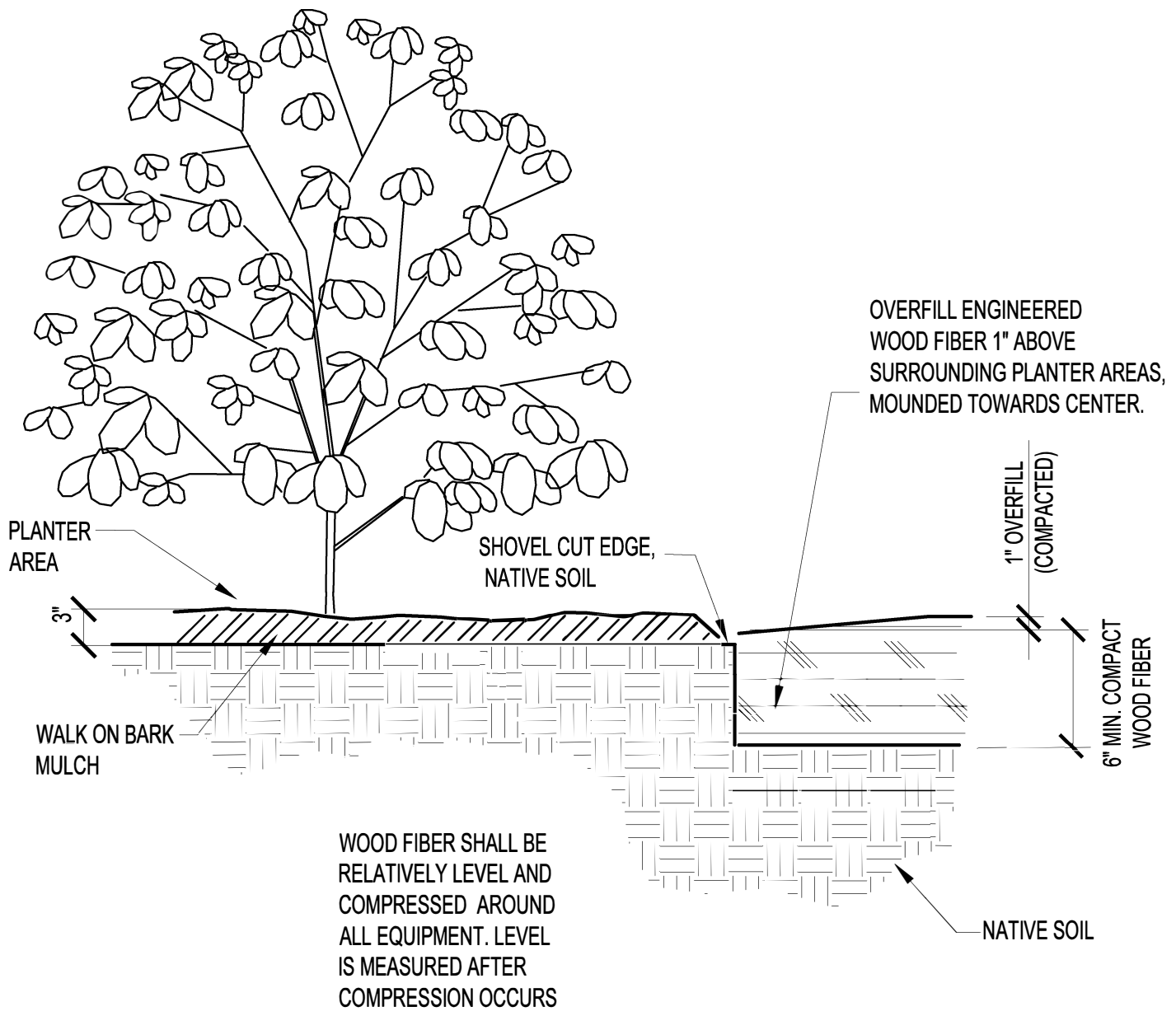

A

EWF SHOVEL CUT EDGE, PLANTER AREA

N.T.S.

SECTION 00 63 13 REQUEST FOR INFORMATION FORM

Project: <u>Polo Community Park Bark Park and</u>	R.F.I. #: <u>9</u>
<u>Landscape Improvements</u>	From: <u>KERN SPRINKLER</u>
To: <u>North of the River Recreation & Park District</u>	Date: <u>11-06-24</u>
Re: <u>ENGINEERED WOOD</u>	Proj. #: <u>POLO-1-2425</u>
<u>FIBER</u>	

Specification Section: _____ Paragraph: _____ Drawing Sheet: _____ Detail: _____
Request

According to the reference notes schedule on sheet LC.01 line item 22 states;
ENGINEERED WOOD FIBER BASE 6" DEPTH, PROVIDED BY OWNER, INSTALLED BY
CONTRACTORL However in the SECTION 00 73 00 SUPPLEMENTARY CONDITIONS OF
THE CONTRACT 1.05 Materials Furnished by NOR. It does not state that NOR is supplying
the wood fiber. Please clarify

Signed By:  Printed Name: Gilbert Carmona Date: MM/DD/YYYY
Response:

1. See Section 01 11 00 (1.03) - Summary of Work. Section has been updated to clarify materials vs. labor on District-provided equipment.

Attachments:

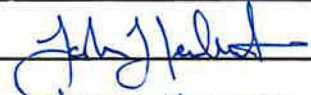
Response From: Bid Administrator To: Bidders Date Open: 11.06.24 Date Rec'd: 11.06.24
Signed by:  Date: 11.06.24
Printed Name: JOSH MERRIBOUDT

END OF SECTION

SECTION 01 11 00 SUMMARY OF WORK

PART I - GENERAL

1.01 Application of the Contract and Inclusion of Division 1

- a. The Contract, General and Supplementary Conditions of the Contract and all Sections of Division 1 apply in full to all other Divisions and Sections of these Specifications as though included therein.

1.02 Description

- a. The Work comprises the completed construction required by the Contract Documents and includes all labor necessary to produce such construction and all materials and equipment incorporated or to be incorporated in such construction. The following is only a partial list of the Work required and is not to be construed as binding in any way. The Contractor is responsible for estimating the actual Work required.

(02) Existing Conditions:

- 02 01 00 – Maintenance of Existing Conditions
- 02 01 10 – Existing Plants to Remain
- 02 41 13 – Selective Site Demolition

(03) Concrete:

- 03 10 00 – Concrete Forming and Accessories
- 03 20 00 – Concrete Reinforcing
- 03 30 00 – Cast-In-Place Concrete
- 03 35 00 – Concrete Finishing

(04) Masonry: N/A

(05) Metals: N/A

(06) Wood, Plastics, and Composites: N/A

(07) Thermal & Moisture Protection: N/A

(08) Openings: N/A

(09) Finishes: N/A

(10) Specialties: N/A

(11) Equipment: N/A

(12) Furnishings: N/A

(13) Special Construction: N/A

(14) Conveying Equipment: N/A

(15) Not Used

(16) Not Used

(17) Not Used

(18) Not Used

(19) Not Used

(20) Not Used

(21) Fire Suppression: N/A

(22) Plumbing: N/A

(23) Heating, Venting, and Air Conditioning (HVAC): N/A

(24) Not Used

(25) Integrated Automation: N/A

(26) Electrical: N/A

(27) Communications: N/A

(28) Electronic Safety and Security: N/A

(29) Not Used

(30) Not Used

(31) Earthwork:

- 31 00 00 – Earthwork and Grading
- 31 10 00 – Site Clearing
- 31 13 13 – Selective Tree and Shrub Removal
- 31 31 00 – Soil Treatment
- 31 31 19 – Vegetation Control

(32) Exterior Improvements:

- 32 05 23 – Cement and Concrete for Exterior Improvements
- 32 31 13 – Chain Link Fences and Gates
- 32 33 00 – Site Furnishings
- 32 80 00 – Planting Irrigation

- 32 90 00 – Planting

(33) Utilities: N/A

(34) Transportation: N/A

(35) Waterway and Marine Construction: N/A

(36) Not Used

(37) Not Used

(38) Not Used

(39) Not Used

(40) Process Interconnections: N/A

(41) Material Processing and Handling Equipment: N/A

(42) Process Heating, Cooling, and Drying Equipment: N/A

(43) Process Gas and Liquid Handling, Purification, and Storage Equipment: N/A

(44) Pollution and Waste Control Equipment: N/A

(45) Industry-Specific Manufacturing Equipment: N/A

(46) Water and Wastewater Equipment: N/A

(47) Not Used

(48) Electrical Power Generation: N/A

1.03 Work Provided by Others

- a. The following work or products shall be provided by NOR and coordinated with the Contractor's work: Landscape boulders, Plant material, Irrigation Controller, Picnic tables, Trash cans, Engineered Wood Fiber (EWF) and all other Bark Park amenities.
 - Landscape boulders – Provided by NOR, installed by Contractor.
 - Plant material – Provided by NOR, installed by Contractor.
 - Irrigation Controller – Provided by NOR, installed by Contractor.
 - Picnic Tables, Trash Cans, Drinking Fountains and Bark Park Site Features – Provided by NOR, installed by Contractor.
 - Engineered Wood Fiber (EWF) – Provided by NOR, installed by Contractor.

1.04 Permits and Fees

- a. The Contractor shall pickup all permits, licenses, and fees required by all governing entities and necessary for successful completion of the Project (NOR will pay building permit and plan review fees). The Contractor is responsible to abide by governing codes and regulations, obtaining inspections, approvals and tests which may be required. Inspection sign-off cards, notices of non-compliance, field plans or other correspondence with governing agencies are property of NOR and shall be returned to NOR after all County or City inspections and approvals are complete.

PART II – PRODUCTS

2.01 Materials and Equipment

- a. The following is only a partial list of materials and equipment to be provided by the Contractor as components of this Work: Irrigation components, Concrete forms and materials, Chain link fencing components and materials, Construction site security, Hydroseed seed and amendments and Planting amendments.

PART III – EXECUTION

3.01 Site Visitation

- a. The General Contractor shall visit the site to review all existing conditions of the premises that may have a bearing on the performance of the Work. Furthermore, the Contractor will personally inspect the grounds for comparison with pertinent sections of the Drawings and Specifications and will immediately notify NOR of any discrepancies. No allowance can subsequently be made on behalf of a Contractor for errors due to negligence in failing to be acquainted with the existing site conditions.

3.02 Layout of Work

- a. Field surveys for control of all grading, construction and layout shall be the responsibility of the Contractor. All such surveys, including construction staking, shall be under the supervision of a California licensed surveyor or civil engineer. Staking shall be performed on all items ordinarily requiring grade and alignment at intervals normally accepted by the agencies and trades involved. Payment of construction survey staking shall be considered as included in the various items of work and no additional allowance will be made therefore.

3.03 Installation

- a. The Contractor shall provide and perform skillful craftsmanship using appropriate tools with current and lawful methods to complete the Work according to the Contract, Plans, and Specifications. Knowledge of and compliance with codes, regulations and procedures of governing agencies, as well as attention to manufacturer's recommendations shall be expected of the Contractor and all employees.

END OF SECTION

SECTION 00 63 13
REQUEST FOR INFORMATION FORM

Project: Polo Community Park Bark Park and R.F.I. #: 10
Landscape Improvements From: Marina Landscape
To: North of the River Recreation & Park District Date: _____
Re: _____ Proj. #: POLO-1-2425

Specification Section: _____ Paragraph: _____ Drawing Sheet: _____ Detail: _____

Request:

1. Refer to LI.00, planting area at parking lot indicates to existing irrigation system installation. However, refer to LP.00, there are trees and hydroseed mix at parking lot. Please confirm if it needs soil preparation at parking lot or not.
2. Please confirm that all wire shall run into new controller shown on sheet LI.01.
3. Please confirm that drip emitter shown on irrigation schedule/LI.01 shall be installed triangle pattern per legend or installed one emitter for each shrub.
4. Please clarify size of lateral line for drip emitter.
5. Refr to 32 90 00 (3.05-b), hydroseed ration shall be separated twice, April 1 and August 15, and August 15 until April 1 respectively. Please proved the ratio of seed mix for bidding purpose, or confirm the time that shall spray seed mix.

Signed By: _____ Printed Name: _____ Date: _____

Response:

1. Yes, soil preparation is required.
2. Correct, wire shall run into controller as shown on Sheet LI.01.
3. Drip emitters shall be installed in a triangular pattern as shown per the legend.
4. Please refer to RFI #5, response 2, in Addendum 2 for lateral size.
5. Section 32 90 00, 3.05(a)(b) have been updated to resolve discrepancy. Timing of Project, after award in November, is anticipated to be 120 days. The seed mix referred to on the plans is for planter areas and shall be the meadow mix listed in Section 32 90 00, 3.05(b)(c).

Attachments:

Response From: Bid Administrator To: Bidders Date Open: 11.05.24 Date Ret'd: 11.06.24

Signed by:  _____ Date: 11.06.24

Printed Name: JOSH HEERBOLDT

END OF SECTION

SECTION 32 90 00 PLANTING

PART I - GENERAL

1.01 Description

- a. Work Included: Plant NOR provided trees and turf seed. Contractor shall off load all delivered materials and be responsible for them upon arrival to the project site. Supply and install other related materials as indicated on the Drawings, specified herein, and needed for a complete and proper installation. The provisions of the General and Supplementary Conditions and Division One apply here.
- b. Related Work Described Elsewhere:
 - (1) Earthwork - Section 31 00 00.
 - (2) Irrigation System - Section 32 84 00.

1.02 Quality Assurance

- a. Use adequate numbers of skilled workmen who are thoroughly trained and experienced in the necessary crafts and who are completely familiar with the specified requirements and methods needed for proper performance of the work of this section.
- b. Standards:
 - (1) Plants and planting material – meet or exceed the specifications of federal, state and county laws regarding inspection for plant disease and insect control.
 - (2) Quality and size – comply with current edition of “Horticultural Standards” for number one nursery stock as adopted by American Association of Nurserymen. All plants shall be true to name, with at least one plant of each bundle or lot tagged with the name and size of the plants in accordance with standards of practice of the American Association of Nurserymen. In all cases, botanical names take precedence over common names.
- c. Inspection: Prior to delivery of any plant materials to the Project site, the Contractor shall make necessary arrangements with NOR for an inspection of the plant material at the offsite location. Any plants found to be unsuitable in growth or condition or which are not true to name shall be removed and replaced with acceptable plants.
- d. Plant Guarantee and Maintenance: The Contractor shall insure that all plant materials remain in a sound, healthy, vigorous condition free from insects, bark abrasions, or other objectionable disfigurements and shall immediately replace any plant which is unacceptable at any time up to and including final acceptance of the Project or completion of the plant establishment period whichever occurs later. Unless otherwise authorized by NOR, the Contractor shall maintain all landscaped areas on a continuous basis as they are completed during the course of work and

until final Project acceptance or the termination of the plant establishment period, whichever occurs later.

1.03 Submittals

- a. Comply with pertinent provisions of Section 01 25 00.
- b. Prior to job acceptance, written certifications shall be submitted to NOR for the following:
 - (1) Quantity and quality of commercial fertilizer and organic fertilizer.
 - (2) Quantity and quality of plant materials.

1.04 Product Handling

- a. Comply with pertinent provisions of the General Conditions, Supplementary Conditions and Division One of the Contract.
- b. Immediately remove from the site plants which are not true to name, and materials which do not comply with the specified requirements, and promptly replace with plants and materials meeting the specified requirements.
- c. Plant protection after delivery to the project site: Plants transported to the site shall be planted as soon as possible. During any interim storage period, they shall not be exposed to excessive sun or drying winds. Any stock that, in the opinion of NOR, has deteriorated due to exposure or has been damaged during transporting will be removed and replaced at the Contractor's expense. Regularly water nursery stock in containers, and place them in a cool area protected from sun and drying winds.

PART II - PRODUCTS

2.01 Fertilizer

- a. Soil Fertilizing Material: Fertilizing material shall comply with the applicable requirements of the State Agricultural Code. All fertilizing material shall be packaged, first grade, commercial quality products identified as to source, type of material, weight and manufacturer's guarantee analysis. It shall not contain toxic ingredients or fillers in quantities harmful to human life, animals or plants. It shall be delivered in unopened containers and shall have the chemical analysis as specified in the Plans or Specifications. Material that has become caked or otherwise damaged shall not be used.
- b. Required Products: Best "Turf Supreme" 16-6-8, Woodace Tablets 14-3-3 with IBDU and Minors.

2.02 Soil Amendment

- a. In general, organic soil conditioners shall consist of a ground or processed wood product derived from redwood, composted and nitrogen stabilized. It shall have a nitrogen content of

1%, a pH not exceeding 7.5, and organic matter not less than 85%. Its gradation shall be such that at least 85% passes the ¼ inch screen.

- b. "Gro-Power Plus" shall have a minimum 4% sulfur.
- c. Chemical soil conditioners such as soil sulfur, gypsum, Best "Soil Buster" or iron additives shall be commercially approved brands designated for agricultural use. Material that has become caked or otherwise damaged shall not be used.

2.03 Tree Stakes

- a. Unless otherwise indicated on the Drawings, provide preservative treated Lodgepole Pine stakes, 2" round x 10 ft. long, complete with tree ties and guying as indicated on the Plans.

2.04 Grass Seed

- a. General – provide grass seed which is:
 - (1) As specified under item 3.05, "Hydroseeding."
 - (2) Free from noxious weed seeds and recycled.
 - (3) Grade A recent crop seed.
 - (4) Delivered to the site in sealed containers with dealer's guaranteed analysis.

2.05 Plant Materials

- a. Provide the plant materials shown on the schedule in the Drawings.
- b. Plant species, sizes, manner in which to be furnished, and the approximate number are shown in the plant list. The quantities, as listed, are approximate and the Contractor shall furnish and install all plant material necessary to complete planting shown on the landscape plan.
- c. Substitutions:
 - (1) All requests for substitutions must be submitted in writing to NOR prior to commencement of work on the Project. The Contractor shall not take any further action concerning his request until a written approval or denial is received from NOR. Plants of kinds other than those indicated on the plant list will be considered by NOR only upon submission of proof that the specified plant is not reasonably procurable in the local region. Substitutions will resemble the specified plant in regards to appearance, ultimate height, shape, habit of growth, climate suitability and general soil requirement.
 - (2) Substitution of a larger size of the same specie may be made by the Contractor without written approval. However, the Contracting Agency will not be responsible for any additional costs incurred by the Contractor, either for the additional cost of the plants or for any additional planting costs.

d. Conditions:

- (1) Plants shall be symmetrical, typical of the variety and species, healthy, vigorous, free from plant disease and insect infestations including eggs, and shall have healthy normal branches and root systems, and fill their containers, but not to the point of being root bound. Plants shall not be pruned prior to delivery, except as authorized by NOR or its representative. In no case shall trees be topped before delivery.
- (2) Flatted plants shall be grown and remain in the flats until transported to the Project site. The soil and spacing of the plants in the flats shall insure the minimum disturbance of the root system at transplanting. Plant shall be well rooted.
- (3) The height and spread of all plant materials shall be measured with branches in their normal position and scaled from the root crown. The caliper of all trees shall be measured 12" (one foot) above the root crown. Palm tree height is to be measured as trunk height from the ground line to the base of the heart leaf. When caliper or other dimensions of any plant materials are omitted from the "Plant Material Legend," it shall be understood that these plant materials shall be normal stock for varieties listed.
- (4) All stock shall have been grown in pots, cans, tubs, or boxes for a minimum of three (3) months and a maximum of one (1) year. They shall have sufficient roots to hold earth together after removal from the containers. This earth shall be free from noxious weeds including Bermuda grass and nut sedge.

2.06 Other Materials

- a. Provide other materials, not specifically described but required for a complete and proper installation, as selected by the Contractor subject to the approval of NOR.

PART III - EXECUTION

3.01 Surface Conditions

- a. Examine the areas and conditions detrimental to timely and proper completion of the Work. Do not proceed until unsatisfactory conditions are corrected.
- b. All scaled dimensions are approximate. Before proceeding with any work, the Contractor shall carefully check and verify all dimensions and quantities and shall immediately inform NOR of any discrepancy between the Drawings and/or Specifications and actual conditions. No work shall be done in any area where there is such a discrepancy until approval for the same has been given by NOR.
- c. Prior to excavation for planting or placing of stakes, locate all utilities, electric cables, conduits, sprinkler lines, heads, valves and valve control wires and all utility lines so that proper precautions may be taken to protect such improvements. In the event of a conflict between such lines and plant locations, promptly notify NOR and arrange for resolution of the conflict.

3.02 Topsoil Preparation and Finish Grading

- a. All lawns and planting areas shall be scarified to a depth of at least eight (8") inches below grade in two directions approximately at right angles prior to placing soil conditioners and fertilizers. All rocks over one inch (1") in size shall be removed from the site.
- b. The soil shall not be worked when the moisture content is so great that excessive compaction will occur nor when it is so dry that nuisance dust will form in the air or that clods will not break readily. Water shall be applied, if necessary, to provide ideal moisture content for tilling and for planting.
- c. Excess soil shall be removed or redistributed before application of soil conditioners. Where soil is to be replaced by plants, allowance shall be made so that when finish grading has begun, there shall be no deficiency in the specified depth of mulched planting beds.
- d. Weeding:
 - (1) Before and during preliminary and finish grading, all weeds and grasses shall be dug out by the roots and disposed of off the site except those weeds and grasses not of the perennial type, less than two and one half inches (2 ½") high and not bearing seeds, which may be turned under. Perennial weeds and grasses shall be removed from the site.
 - (2) All landscape and planting areas, except those intended for lawns, shall be treated with a pre-emergent control, in accordance with the manufacturer's recommendations.
- e. After clearing, grubbing and earthwork has been completed, all turf areas shall receive Best "Soil Buster" or equal at the rate of 1500 lbs. per acre and Best "Turf Supreme" 16-6-8 at 272 lbs. per acre cultivated evenly in two directions into the top six (6") inches of soil.
- f. When preliminary grading, including weeding and soil conditioning, has been completed and the soil has dried sufficiently to be readily worked, all lawn and planting areas shall be graded to the elevation indicated on the Drawings. Grades not otherwise indicated shall be uniform level planes and slopes between points where elevations are given. Minor adjustments of finish grades shall be made at the direction of NOR. Finish grade shall be a smooth, even and uniform plane without abrupt grade changes. Slope soil areas adjacent to buildings away from the buildings to allow a natural "run-off" of water. Surface drainage shall be directed as indicated on the Drawings by shaping surfaces to facilitate the natural "run-off" of water. Low spots and pockets shall be graded to drain properly. Finish grade of all lawn areas shall be one inch below grade of adjacent pavement of any kind. Grading shall be done when soil is at optimum moisture content for working. Finish grades shall be to within one tenth (1/10) of one (1) foot.
- g. If any trenches are dug after grading and fertilizing is completed, the upper portion of the trench backfill shall be retiled and fertilized to a depth specified for the area as required to conform to the specifications.

3.03 Planting Trees and Shrubs

a. General:

- (1) No planting shall be done until all operations in conjunction with the installation of the sprinkler system have been completed, final grades have been established, the planting areas have been properly graded and prepared as herein specified, and the work approved by NOR.
- (2) Position plants at locations indicated on Drawings and secure NOR acceptance before excavating pits. Make necessary adjustments as required.
- (3) The planting pits for trees and shrubs shall be excavated to a volume twice the diameter and twice the depth of the root ball. After the plant pit has been excavated, it shall be filled with water and allowed to settle. The backfill mix for use around the root ball shall meet the following specifications:
 - A. Backfill mix shall consist of one part organic soil conditioner, two parts native soil creating one cubic yard of mix. To this mix add 15 lbs. "Gro-Power" with 4% sulfur or approved equal.
 - B. The backfill shall be produced by thoroughly combining these components into a homogeneous mixture. The Contractor shall notify NOR prior to mixing prepared soil so they may observe the mixing process. In addition, during backfilling, slow release fertilizer tablets, Woodace 16 gram tablets with a 14-3-3 analysis plus minors, shall be added in the following quantities:

For one-gallon	5 tablets
For five-gallon	9 tablets
For fifteen-gallon	15 tablets
For twenty-four inch or larger box	20 tablets

- (4) While the plant pit is still moist, place a layer of prepared soil mix in the pit and tamp before setting plant into position. All plants shall be carefully removed from their containers and set so that they are at the same elevation they grew at in the container before being transplanted. Each plant shall be planted vertically in the center of the pit and backfilled with the prepared soil unless otherwise specified. All broken or frayed roots shall be properly cut off. The plant shall be placed so as to present the best appearance with relationship to adjacent plants and structures. It shall be rigidly constrained until backfilling with prepared soil mix and slow release fertilizer tablets is complete. The backfill will be thoroughly settled by tamping and watering so that all voids are filled.
- (5) Plants shall not be allowed to dry out before or while being planted. Keep exposed roots moist at all times during planting by using wet sawdust, peat moss, or burlap. Do not expose roots to the air except while being placed in the ground. Wilted plants, whether in place or not, will not be accepted and shall be replaced at the Contractor's expense.
- (6) As shown on the Drawings, construct a firmly compacted mound of soil around each tree and plant to form a watering basin at the edge of and following the shape of the root ball

circumference. Mounds for trees and other plants from five-gallon or larger containers shall be at least two (2") inches high. Excavated earth, if capable of retaining water, may be used. Refill any settlement within the basins after watering with prepared soil and additional nitrogen stabilized sawdust worked into the surface as required to restore the mulched condition. At the end of the maintenance period all watering basins in the lawn areas shall be leveled to the finish grade of the sod. These areas shall be seeded or stolonized with the specified mix.

- (7) Trees shall be supported by tree stakes with a VIT twist brace placed high for maximum support. After planting, the plants shall be pruned according to accepted standards for transplanting materials.

3.04 Planting Ground Cover

- a. Ground Cover Areas: The planting beds shall be brought to finish grade before mixing 2 cubic yards of organic soil conditioner and 150 lbs. Gro-Power per 1000 square feet. Fertilizing and conditioning material shall be mechanically spread and uniformly cultivated into the upper eight (8") inches of soil using suitable equipment. The remaining soil shall be in a friable condition suitable for planting. A pre-emergence control application is required prior to planting.
- b. Rake prepared soil smooth and free from soil lumps, rocks, sticks and other deleterious materials.
- c. Planting:
 - (1) Space the ground cover plants evenly as indicated on the Drawings, staggering the spaces around shrubs and trees as well as in the open areas.
 - (2) Pits for flatted plants shall be sufficient to allow roots to be spread out in the pit. Ground cover areas shall be moistened prior to planting. No flatted plants shall be planted in dry soil. Set plants in center of pits and backfill so that the crown of a plant will be level with the finished grade after the soil settles. Thoroughly water all ground cover areas after planting.
 - (3) If planting in the open on hot days, shorten the time between planting and watering.
 - (4) After planting, rake the planting area to restore an even surface and to provide drainage.

3.05 Sowing Seed, Turf Grass and Natural Planter Areas

- a. Preparation:
 - (1) Grade seed beds, thoroughly removing ridges and depressions, and making areas smooth continuous firm planes that ensure proper drainage.
 - (2) Remove soil lumps, rocks, sticks and other deleterious materials.

b. Hydroseeding:

- (1) Application Equipment: Mixing shall be performed in a tank with a built in continuous agitation and recirculation system of sufficient operating capacity to produce a homogeneous slurry of fiber, seed, fertilizer and water in the designated proportions and a discharge system which will apply the slurry to the area to be treated at a continuous and uniform rate.
- (2) Loading and Mixing: With agitation system operating at part speed, water shall be added to the tank and a good circulation shall be established.

A. Materials shall be added to the tank in such a manner that they are uniformly blended into the mixture in the following sequence:

- 4100 gal water/acre (1500 gal tank - 3 tanks/acre)
- 1500 lbs./acre conwed fiber
- 100 lbs./acre Ecology Control M Binder

B. Grass Seed shall be applied as follows: Cynoden dactylon-Bermuda grass (hulled), three (3) pounds per 1,000 square feet if planted between April 1 and August 15; four (4) pounds unhulled Bermuda and six (6) pounds Festuca glauca rubra – Creeping Red Fescue per 1,000 square feet after August 15 until April 1.

C. NOR seed mix for planter areas shall be as follows:

	PO Box 1275		
	Carpinteria, CA 93014-1275 - USA		
	Tel. 805-684-0436 * Fax 805-684-279A8		
Contact Name	Steph Thisius <sthisius@norrecreation.org>	Site Location	Kern Co
Group	North of the River Recreation and Park District	Size of Project	TBD
Project Name	NOR Standard Mixes	Irrigation	Yes
Design needed by	8/21/2023 (current)	Design Objectives	Savannah/Mass Planting/Clean
Installation Date	TBD	Site Details/Slope/Soil	<3ft, Parking Islands, Heat
Species	Common Name	Bulk Lbs/Acre	
Achillea millefolium	Yarrow	2.00	
Aristida purpurea	Purple Threeawn	2.00	
Elymus elymoides	Squirreltail	6.00	
Eschscholzia californica	California Poppy	4.00	
Gilia tricolor	Birds Eye Gilia	2.00	
Lasthenia californica	Goldfields	1.00	
Stipa pulchra	Purple Needlegrass	4.00	
Sporobolus airoides	Alkali Sacaton	2.00	
Festuca microstachys	Pacific Fescue	6.00	
Gutierrezia californica	Matchweed	2.00	
Phacelia campanularia	Desert Bluebells	3.00	
Festuca idahoensis	Idaho Fescue	2.00	

D. Contractor is to indicate square footage of coverage of each tank full of mix so that NOR may verify appropriate product application.

- (3) The Contractor shall be responsible for maintenance of all seeded areas until they are accepted by the Contracting Agency. This shall include watering, mowing at regular intervals (for turf areas), weeding and removal of all debris.

- (4) Promptly after seeding, wet the seed bed thoroughly and keep all areas moist throughout the germination period. Watering to commence after completion of seeding and to continue at a rate necessary to keep mulch moist without drying out or puddling. Normally irrigating ONCE AN HOUR for a short duration as approved by NOR, and continuing this procedure each and every daylight hour, seven days a week will be sufficient. This continual moist condition to prevail each and every day until rooting state is complete. Irrigation should continue on the basis of at least once or twice a day until seed is well established as determined by Owner.

3.06 Maintenance

- a. Maintain plantings, starting with the planting operations and continuing for sixty (60) calendar days after the Project is complete and approved by NOR. This period may be extended due to improper maintenance or appreciable plant mortality.
- b. Work Included:
 - (1) Watering, weeding, cultivation, spraying, fertilizing, edging, mowing and pruning as necessary to keep the plant materials in a healthy growing condition and to keep the planted areas neat and attractive throughout the maintenance period.
 - (2) Adjust the irrigation system and/or provide equipment and means for proper application of water to those planted areas not equipped with an irrigation system. Apply water in sufficient quantities and as often as seasonal conditions require to keep the ground wet at all times. Moisture should percolate well below the root system of grass and plantings. Do not cause erosion when watering slopes.
 - (3) Protect planted areas against damage, including erosion and trespassing, by providing and maintaining proper safeguards.
- c. Replacements:
 - (1) During the maintenance period, should the appearance of any plant indicate weakness and probability of dying immediately replace that plant with a new and healthy plant of the same type and size without additional cost to NOR. Replacement shall be made with plant materials as indicated or specified for the original planting and all such replacement materials shall be guaranteed as specified for the original guaranteed materials.
 - (2) Any lawn areas or ground cover or slope areas that do not show a prompt growth of grass or establishment of plant material shall be reseeded, resodded or replanted at ten (10) day intervals until accepted by NOR.
 - (3) At the end of the maintenance period, all plant material shall be in a healthy growing condition.
- d. Disease and Pest Control: Throughout the maintenance period all plants shall be maintained in a disease and pest free condition. A licensed pest control operator shall be retained by the Contractor to recommend and apply pesticides, herbicides and fungicides.

- e. Pruning: All shrubs and trees shall be pinch pruned as necessary to encourage new growth and to eliminate rank sucker growth. Old flowers and dead foliage and limbs shall be removed. No major pruning shall be done without the approval of NOR.
- f. Lawns:
 - (1) Grass shall be mowed, minimum two (2) cuttings, with reel type mowers before it exceeds two (2") inches in height. Bermuda grass shall be cut at a height of not less than three eighths (3/8") of an inch and not more than one (1") inch in height. Grass clippings shall be collected during mowing operations and removed from the site. After each cutting the edge of the grass shall be trimmed to a neat condition until acceptance of work by NOR.
 - (2) The Contractor or his workmen shall not walk unnecessarily on lawn areas before, during or after planting. Damaged or compacted lawn areas shall be recultivated and replanted.
- g. The Contractor will be relieved from landscape maintenance work when the final thirty (30) calendar days work has been completed and NOR is satisfied that the plant material appears in healthy and well established condition.

END OF SECTION

SECTION 00 63 13 REQUEST FOR INFORMATION FORM

Project: Polo Community Park Bark Park and R.F.I. #: 11
Landscape Improvements From: North of the River Recreation & Park District
To: North of the River Recreation & Park District Date: 11/07/2024
Re: Bid Close Date Extended Proj. #: POLO-1-2425

Specification Section: _____ Paragraph: _____ Drawing Sheet: _____ Detail: _____
Request: _____

Signed By: _____ Printed Name: _____ Date: _____
Response: _____

The Bid submittal deadline for this project has been extended to **Tuesday, November 12th at 2:00pm.**

Attachments: _____

Response From: Bid Administrator To: Bidders Date Open: 11.07.24 Date Ret'd: 11.07.24

Signed by:  _____ Date: 11.07.24

Printed Name: JOSH HERZBOLDT _____

END OF SECTION